



LIFESENSE®

## Body Analysis Smart Scale

Consistent, accurate  
measurements



### FACT BOX

Product Code:

MD1816

Product Category:

Diagnostics.

Product Approvals:

CE marked.

Capacity:

180kg/397lb/28st 5lb.

Power:

3 x AAA Batteries (Included)



Scan above to download our free

**MEDICARE LIFESENSE APP**

Measure, Track and Share your Results



The Medicare LifeSense® Body Analysis Smart Scale provides high-accuracy measurements and a detailed analysis of your body composition. Body weight alone does not give you a full picture of your health. Learning what's behind the numbers can give you the power to improve your overall wellbeing. Using our highly accurate Body Analysis Smart Scale you can keep track of more than just your weight with the ability to measure body mass index (BMI), body fat, muscle mass and more. Easily transfer your results via Bluetooth to our Medicare LifeSense® App where you can monitor your progress over time.

### FEATURES

- Measures Body Weight, Body Mass Index (BMI), Body Fat Percentage, Body Water Percentage, Muscle Mass, Bone Mass, Basal Metabolic Rate (BMR), Visceral Fat and Body Age.
- Sense-On Technology for instant activation.
- 4 x Precision G Sensors for consistent accuracy.
- BIA Technology for highly accurate measurements.
- Unlimited amount of users.

### RECOMMENDED USE:

For health management & monitoring.

Barcode: 5099390417852



@Medicarefirstaid



@Medicarefirstaid



@Medicare1staid



LIFESense®

## Body Analysis Smart Scale

Consistent, accurate  
measurements



### MEASURE, TRACK & SHARE YOUR RESULTS

The Medicare LifeSense® App saves all your body composition measurements and creates a comprehensive chart to help build a picture of your long-term progress.

Compare your previous numbers or share your information with your doctor, pharmacist or personal trainer via email from the app.

The app also allows you to set reminders to weigh yourself as it is recommended to do so at the same time of day. You can also access all your information from the Medicare LifeSense® online portal at [app.flemingmedical.ie](http://app.flemingmedical.ie).

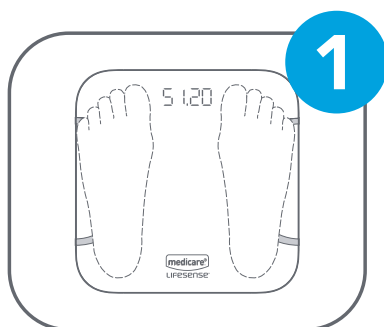

Place the scale on a hard, flat floor. Make sure you are barefoot. Ensure your feet touch the four electrodes during measurement.

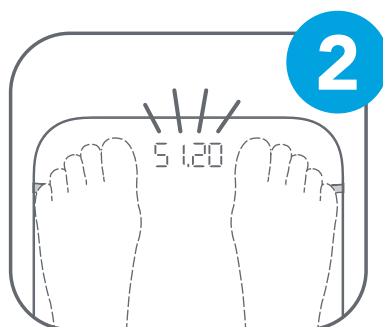

Stand on the scale surface to measure your weight and body fat. The measurement is completed when the value on the LED screen is flashing.

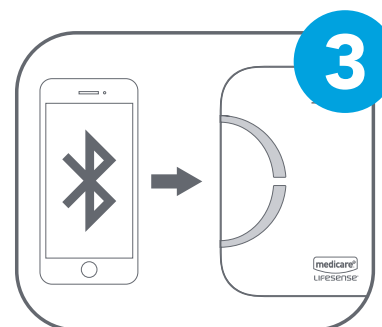

Once the measurement has been completed, your results will be displayed on the screen of the device and also synced to the app.



@Medicarefirstaid



@Medicarefirstaid



@Medicare1staid